

Serial Number: RFP-FQ15093/GG
Date of Issue: April 16, 2015
Proposal Due Date: Aug 31, 2015

WASHINGTON METROPOLITAN AREA TRANSIT AUTHORITY
600 FIFTH STREET, N.W.
WASHINGTON, D.C. 20001

August 21, 2015

AMENDMENT NO. 4
TO
REQUEST FOR PROPOSALS
FOR
REHABILITATION OF RED LINE METRO RAIL SYSTEM FROM FRIENDSHIP HEIGHTS CROSSOVER
TO GROSVENOR - STRATHMORE STATION
FQ15093/GG

TO WHOM IT MAY CONCERN:

The Request For Proposals for Proposal Documents accompanying RFP FQ15093/GG requesting Proposals for the above project are hereby changed in part as listed below.

1. Volume 1 – Division 0

Delete the following pages and in lieu thereof replace the accompanying pages:

<u>DELETE</u>	<u>REPLACE</u>	<u>DESCRIPTION</u>
00010-4	00010-4AM4	Revised
00434	00434 AM4	Revised
00800-19	00800-19 AM4	Revised
Appendix D to Section 00867	Appendix D to Section 00867 AM4	Revised

ADD:
00800-20

2. Volume 1 – Division 1

Delete the following pages and in lieu thereof replace the accompanying pages:

<u>DELETE</u>	<u>REPLACE</u>	<u>DESCRIPTION</u>
01110-04	01110-04 AM4	Revised
01110-05	01110-05 AM4	Revised
01110-06	01110-06 AM4	Revised
01110-09	01110-09 AM4	Revised
01111-04	01111-04 AM4	Revised
01112-12	01112-12 AM4	Revised
01112-13	01112-13 AM4	Revised

3. Volume 2 – Divisions 2 through 16

Delete the following pages and in lieu thereof replace the accompanying pages:

<u>DELETE</u>	<u>REPLACE</u>	<u>DESCRIPTION</u>
---------------	----------------	--------------------

4. Volume 3 – RFP Drawings for construction part of the Work and RFP Drawings for design-build part of the Work

Delete the following drawings and in lieu thereof add the accompanying drawings:

<u>DELETE</u>	<u>ADD</u>	<u>DESCRIPTION</u>
A11-A-551	A11-A-551 AM4	Revised
A11-M-350	A11-M-350 AM4	Revised

5. Volume 10 – Attachments

Delete the following pages and in lieu thereof replace the accompanying pages:

<u>DELETE</u>	<u>REPLACE</u>	<u>DESCRIPTION</u>
---------------	----------------	--------------------

6. Acknowledgment

Proposers are required to acknowledge receipt of this Amendment on the Technical and Price proposal Forms (p.00412-1 and p.00413-1) in the space provided. Failure to acknowledge all Amendments may cause the Proposal to be considered non responsive to the RFP, which would require rejection of the Proposal.

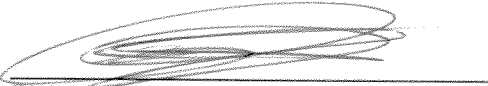

Richard Owens
Contracting Officer

Enclosures

* * * * *

- 00811 Subcontract Agreements
- 00812 Other contracts
- 00824 Period of Performance and Project Schedule
- 00830 Dispute Resolution
- 00833 Authority Furnished Property
- 00841 Consideration and Basis of Payment
- 00844 Method of Payment
- 00867 Davis Bacon and Copeland Anti-Kickback Acts
- 00877 Indemnification and Insurance Requirements
- 00878 Liquidated Damages
- 00888 Federal Regulations and Clauses
- 00889 Partnering
- 00890 Availability of Funds for the Next Fiscal Year
- 00891 Living Wage
- 00892 Notification of Federal Participation
- 00893 Community Outreach
- 00894 Project Management Software System

AM4

Appendix D to Section 00867, Wage Determination Rates

00900 Amendments and Modifications

- 00910 Amendments
- 00920 Claims
- 00930 Clarifications and Proposals
- 00940 Modifications

END OF SECTION

0434 Price Schedule - Submit with Price Proposal

BI #	Discription	QTY	Unit Price	Unit	Total
Part 2.1.1 Tunnel Rehabilitation & Medical Center Station Ceiling Replacement					
Medical Center Station Ceiling Replacement:					
2.1.1.1A	Complete Ceiling replacement with New Acoustical snap-in metal pan ceilings , light fixtures , conduit , wiring, and Misc. devices in the Passageway	1	-	LS	\$
2.1.1.1B	Complete Ceiling replacement with New Acoustical snap-in metal pan ceilings , light fixtures , conduit , wiring, and Misc. devices under Mezzanine	1	-	LS	\$
2.1.1.2A	Removal & Replacement Medical Center Pasageway Hatch	1	-	LS	\$
2.1.1.2B	Passageway Waterproofing Coatings	1	-	LS	\$
Tunnel Rehabilitation:					
2.1.1.3A	Clean with power wash/hand tool the concrete lining, vault and end walls	1	-	LS	\$
2.1.1.3B	Remove heavy efflorescence on electrical cables	4,940	\$	SF	\$
2.1.1.3C.1	Type 1 T concrete repair	5,350	\$	LF	\$
2.1.1.3C.2	Type 2 T concrete repair	1,925	\$	LF	\$
2.1.1.3C.3	Type 3 T concrete repair	28	\$	SF	\$
2.1.1.3C.4	Type 4 T concrete repair	47	\$	SF	\$
2.1.1.3C.5	Type 5 T concrete repair	10	\$	EA	\$
2.1.1.3C.6	Type 6 T concrete repair	100	\$	LF	\$
2.1.1.3D	Grating and floor plates	1	-	LS	\$
2.1.1.3E	Replace/Clean/repair Subway drainage system and Manholes	1	-	LS	\$
2.1.1.4A	Remove and replace existing ETS and ETS relay cabinets with all terminations in the tunnel areas	1	-	LS	\$
2.1.1.4B	Install All cables for ETS in tunnel including Mounting hardware	1	-	LS	\$
2.1.1.4C	Complete installation of ETS outside tunnel areas including cables testing	1	-	LS	\$
2.1.1.5A	Install Complete Load Center Cabinets w/Transformer, including mounting hardware and all wire terminations	1	-	LS	\$
2.1.1.5B	Install Duplex waterproof outlets, including NEMA 4x and mounting hardware and all wire terminations	1	-	LS	\$
2.1.1.5C	Install as per drawings all other Cables Except ETS cables in tunnel including Mounting hardware	1	-	LS	\$
2.1.1.5D	Remove and replace deteriorated, broken, missing Clamps for cables and conduits, miscellaneous devices, boxes, covers and hardware in tunnel.	15,000	-	EA	\$
2.1.1.5E	Install new Light fixtures in tunnel including Mounting hardware and terminations	1	-	LS	\$
2.1.1.5F	Remove in tunnel segment all existing unused light fixtures, cables, Load Center Cabinets with Transformer, mounting hardware, and Duplex waterproof outlets	1	-	LS	\$
Sub Total for Part 2.1.1 Tunnel Rehabilitation & Medical Center Station Ceiling Replacement					[A] \$
Part 2.1.2 Medical Center Crossover Waterproofing					
2.1.2.6	Installation of Medical Center Crossover Waterproofing as per drawings and specifications	1	-	LS	\$
Sub Total for Part 2.1.2 Medical Center Crossover Waterproofing					[B] \$
Part 2.1.3 Grosvenor Aerial Bearing Replacement, Drainage and Pier Cap Retrofits					
2.1.3.7	Hammer Head Construction (20 Each)	1	-	LS	\$
2.1.3.8	Grout Pads - New & Repair Existing	1	-	LS	\$
2.1.3.9	Bearing Replacement (at 4 Piers)	1	-	LS	\$
2.1.3.10	Deck Joint Replacement	1	-	LS	\$
2.1.3.11	Plumbing at Piers	1	-	LS	\$
Sub Total for Part 2.1.3 Grosvenor Aerial Bearing Replacement, Drainage and Pier Cap Retrofits					[C] \$
Part 2.1.4 Grosvenor Station Platform Rehabilitation					
2.1.4.12	Platform Structural Slab Edge demo and replacement	1	-	LS	\$
2.1.4.13	Granite Edge Removal and Replacement including waterproofing	1	-	LS	\$
2.1.4.14	Platform Paver Tile , topping Slab setting bed Removal and Replacement including waterproofing	1	-	LS	\$
2.1.4.15A	Platform Concrete structural Slab repair: Type 3 concrete repair	20	\$	SF	\$
2.1.4.15B	Platform Concrete structural Slab repair: Type 4 concrete repair	10	\$	SF	\$
2.1.4.15C	Platform Concrete structural Slab repair: Type 7 concrete repair	70	\$	LF	\$
2.1.4.15D	Platform Concrete structural Slab repair: Type 8 concrete repair	70	\$	LF	\$
2.1.4.16	Mechanical- Demo Standpipe and install new standpipe	1	-	LS	\$
2.1.4.17	All Electrical related work as per drawings but not limited to New Platform edge lights, Station lights upgrade, Reroute cables & conduits, Install new conduit & cables.	1	-	LS	\$
Sub Total for Part 2.1.4 Grosvenor Station Platform Rehabilitation					[D] \$
Part 2.1.5 Grosvenor Platform Canopy and Mezzanine Roof Restoration					
Design:					
2.1.5.18	Canopy Mezzanine - Design (Design, As-built, Documents, Review and Approvals)	1	-	LS	\$

AM4

AM2
AM3
AM3

- B. The Authority will contact those residents and business owners who might reasonably be expected to be affected by the construction and make known to them the name of the Authority’s representative on the worksite with responsibility for community outreach and explain to them the means by which the representative can be contacted expeditiously.
- C. Design-Builder shall designate an on-Site, community outreach liaison with 24-hour, on-call availability for the duration of the Contract. Community outreach liaison duties include:
 - 1. Staying informed of problems caused by the construction.
 - 2. Assisting the Authority in notifying adjacent owners of upcoming work.
 - 3. Preparing and posting advance notice signs as necessary to inform public and surrounding businesses of upcoming construction activities.
 - 4. Assisting the Authority in responding to complaints.
 - 5. Attending public outreach meetings, as necessary. Meetings can include regular construction information meetings, quarterly open houses, media inquiries, tours, ground breaking, and other milestone events.
 - 6. Accommodating Site tours. Tours shall be arranged through the Contracting Officer Representative.

00894 PROJECT MANAGEMENT SOFTWARE SYSTEM

AM4

The Design-Builder shall use the Authority’s internet based project management software system for submitting, reviewing and tracking documents of this Contract, The system is provided and administered by the Authority and is currently called “Procore”.

The Design-Builder shall use this internet, web based project management software system to manage all the documents issued to the Authority. This system was selected by the Authority and is designed to address the record keeping and communications requirements for the Authority’s contracts, including this Contract.

AM4

The Design-Builder is encouraged to include this requirement in contracts with its subDesign-Builders to facilitate the flow of documentation. If a subcontract is executed without this requirement it shall not relieve the Design-Builder’s obligation to the Authority.

AM4

1. The Authority retains control and ownership of the system’s database during the duration and upon completion of the Contract.

AM4

2. The Design-Builder shall, at no additional cost to the Authority, provide the necessary equipment and services at the Design-Builder’s facilities to actively participate in the above mentioned internet based project management software system.

AM4

As a minimum, this requirement shall include:

a. All hardware to operate the system at the Design-Builder’s facilities.

b. The necessary telephone or other data lines to connect the hardware to the internet at the Design-Builder’s facilities [a Digital Subscriber Line (DSL) is the minimum recommended for optimum performance];

AM4

c. An internet service provider for access by the Design-Builder's personnel to the Web site of the internet based project management software system; and **AM4**

d. the necessary project personnel to participate.

3. The Authority will provide informal training to Design-Builder's key project personnel in using the internet based project management software system. Training will be provided at the Authority's location that will be determined after the Contract award. The number of individuals that will be trained shall be limited to only those Design-Builder's employees who will actively participate in the system. **AM4**

4. The Authority reserves the right during the period of this Contract to expand the data that is to be entered into the internet based project management software system for document control. Should the Authority replace Procore with any other project management software system, the same requirements as listed in this Section 00894 shall remain valid. **AM4**

APPENDIX D - WAGE DETERMINATION OF THE SECRETARY OF LABOR

END OF SECTION

APPENDIX D TO SECTION 00867, WAGE DETERMINATION RATES

General Decision Number: DC150001 08/14/2015 DC1

Superseded General Decision Number: DC20140001

State: District of Columbia

Construction Types: Heavy (Heavy and Sewer and Water Line)
and Highway

County: District of Columbia Statewide.

HEAVY CONSTRUCTION PROJECTS (Including Sewer and Water Lines);
HIGHWAY CONSTRUCTION PROJECTS

Note: Executive Order (EO) 13658 establishes an hourly minimum wage of \$10.10 for 2015 that applies to all contracts subject to the Davis-Bacon Act for which the solicitation is issued on or after January 1, 2015. If this contract is covered by the EO, the contractor must pay all workers in any classification listed on this wage determination at least \$10.10 (or the applicable wage rate listed on this wage determination, if it is higher) for all hours spent performing on the contract. The EO minimum wage rate will be adjusted annually. Additional information on contractor requirements and worker protections under the EO is available at www.dol.gov/whd/govcontracts.

Modification Number Publication Date

0	01/02/2015
1	01/09/2015
2	03/06/2015
3	05/01/2015
4	05/08/2015
5	06/05/2015
6	06/12/2015
7	06/26/2015
8	07/03/2015
9	07/17/2015
10	08/07/2015
11	08/14/2015

ASBE0024-001 10/01/2013

Rates Fringes

Asbestos Worker/Heat and
Frost Insulator

Includes the application
of all insulating
materials, protective
coverings, coatings and
finishes to all types of
mechanical systems.....\$ 33.13 13.76

ASBE0024-002 10/09/2013

Rates Fringes

HAZARDOUS MATERIAL HANDLER

Includes preparation,
wetting, stripping,
removal, scrapping,
vacuuming, bagging and
disposing of all
insulation materials,
whether they contain
asbestos or not, from
mechanical systems.....\$ 20.86 5.46

ASBE0024-005 10/01/2013

Rates Fringes

Fire Stop Technician.....\$ 26.06 5.90

Includes the application of materials or devices within or
around penetrations and openings in all rated wall or floor
assemblies, in order to prevent the pasage of fire, smoke
of other gases. The application includes all components
involved in creating the rated barrier at perimeter slab
edges and exterior cavities, the head of gypsum board or
concrete walls, joints between rated wall or floor
components, sealing of penetrating items and blank openings.

BOIL0193-001 01/01/2014

	Rates	Fringes
Boilermakers:.....	\$ 38.07	22.58

BRDC0001-001 05/03/2015

	Rates	Fringes
Bricklayer.....	\$ 30.36	9.69

BRMD0001-004 05/03/2015

	Rates	Fringes
BRICKLAYER		
Refractory (Firebrick).....	\$ 36.62	9.85

* CARP0132-001 05/01/2015

	Rates	Fringes
Carpenter/Lather.....	\$ 27.56	9.08
Piledriver.....	\$ 26.79	8.85

CARP1831-001 04/01/2013

Rates	Fringes
-------	---------

MILLWRIGHT.....\$ 31.59 8.58

CARP2311-002 05/01/2013

Rates Fringes

DIVER TENDER.....\$ 29.00 8.15

DIVER.....\$ 37.74 8.15

ELEC0026-001 11/03/2014

Rates Fringes

Electricians.....\$ 42.40 14.97

ELEC0070-001 05/04/2015

Rates Fringes

Line Construction:

Cable Splicers.....\$ 35.35 19%+5.00

Equipment Operators.....\$ 35.35 19%+5.00

Groundmen.....\$ 16.44 19%+5.00

Linemen.....\$ 35.35 19%+5.00

Truck Driver.....\$ 18.69 19%+5.00

ENGI0077-001 05/01/2015

Rates Fringes

Power equipment operators:

(HEAVY AND HIGHWAY

CONSTRUCTION)

GROUP 1.....	\$ 35.91	8.65+a
GROUP 2.....	\$ 34.36	8.65+a
GROUP 3.....	\$ 32.71	8.65+a
GROUP 4.....	\$ 29.30	8.65+a
GROUP 5.....	\$ 25.28	8.65+a
GROUP 6.....	\$ 23.23	8.65+a
GROUP 7.....	\$ 36.75	8.65+a

POWER EQUIPMENT OPERATORS CLASSIFICATIONS

GROUP 1: Tower Cranes and Cranes 100 ton and over.

GROUP 2: 35 ton cranes & above, derricks, concrete boom pump, drill rigs (+50,000 lbs torque), mole.

GROUP 3: Cranes, hoists, drill rigs (under 50,000 lbs torque), tie back machines, paving mixers, tunnel shovels, batch plants, shields, tunnel mining machines, draglines, mucking machines, graders in tunnels, pile driving engines, welder, horizontal directional drill operator, Tug boats.

GROUP 4: Front end loaders, boom trucks, backhoes, excavators, gradalls, power driven wheel scoops & scrapers, blade graders, motor graders, bulldozers, trenching

machines, ballast regulator, hoe ram, locomotive (standard, narrow gauge, tuggers).

GROUP 5: Boilers (skelton), asphalt spreaders, bullfloat finishing machines, concrete finishing machines, concrete spreaders, concrete mixer, concrete pump, well points, hydraulic pumps, elevators, freeze uniits, tunnel motorman or dinky operator, conveyors, grout pump, fireman, ultra high pressure water jet cutting tool system operator/mechanic, horizontal directional drill locator, skid steers (fine grading), High lifts (lull type lifts).

GROUP 6: Fork lifts, ditch witch, bobcat, skid steer, space heaters, sweepers, assistant engineers, oilers, service unit equipment, roller.

GROUP 7: Master mechanic.

a. PAID HOLIDAYS: New Years Day, Inaugural Day, Decoration Day, Independence Day, Labor Day, Martin Luther King's Birthday, Veterans' Day, Thanksgiving Day, Friday after Thanksgiving and Christmas Day.

ENGI0077-002 06/01/2015

Rates Fringes

Power equipment operators:

(PAVING AND INCIDENTAL

GRADING)

GROUP 1.....	\$ 28.99	7.35
GROUP 2.....	\$ 25.85	7.35
GROUP 3.....	\$ 22.24	7.35
GROUP 4.....	\$ 20.00	7.35
GROUP 5.....	\$ 29.70	7.15

POWER EQUIPMENT OPERATORS CLASSIFICATIONS

GROUP 1: Gradall operator, Crane.

GROUP 2: Boom Truck, Milling Machine, Excavator, Rubber Tire Backhoe, Asphalt Paver, Asphalt Plant Engineer, Motor Grader, Track Loader, Rubber Tire Loader, Track Dozer, Concrete Paver.

GROUP 3: Broom Truck, Asphalt Roller.

GROUP 4: Air Compressor, Grade Rollers.

GROUP 5: Mechanic.

ENGI0077-003 07/01/2015

Rates Fringes

Power equipment operators:

(SEWER, GAS AND WATER LINE

CONSTRUCTION)

GROUP 1.....	\$ 25.60	7.35+a
GROUP 2.....	\$ 25.20	7.35+a

GROUP 3.....	\$ 24.69	7.35+a
GROUP 4.....	\$ 24.37	7.35+a
GROUP 5.....	\$ 23.55	7.35+a

POWER EQUIPMENT OPERATORS CLASSIFICATIONS

GROUP 1: Excavators, Cranes, Gradalls.

GROUP 2: Backhoes, Front-end Loaders, Fork alift/Lull, Bulldozers, Motor Graders. Qualified Mechanics, Hydraulic Tamper and Hoe Pack, Paving Mixers, Pile Driving Engines, Batch Plant, Concrete Pumps, Low-Boy Driver, Lube Truck.

GROUP 3: Trenching Machine, Well Drilling Machines, Concrete Mixers, Motor Graders, Truck Driver.

GROUP 4. Roller, Air Compressors, Pumps, Welding Machines, Well Points, Firemen.

GROUP 5: Oiler

a. PAID HOLIDAYS: New Year's Day, Inaugural Day, Washington's Birthday, Decoration Day, Independence Day, Labor Day, Veterans Day, Thanksgiving Day, Christmas Day and Martin Luther King's Birthday.

IRON0005-001 06/01/2015

Rates Fringes

Ironworkers:

Structural, Ornamental and

Chain Link Fence.....\$ 30.65 18.135

IRON0201-001 05/01/2015

Rates Fringes

Ironworkers:

Reinforcing.....\$ 27.50 18.58

LABO0657-003 06/01/2015

Rates Fringes

Laborers: (HEAVY AND HIGHWAY
AND SEWER & WATER LINES
CONSTRUCTION)

GROUP 1.....\$ 23.67 7.31

GROUP 2.....\$ 24.06 7.31

GROUP 3.....\$ 24.27 7.31

GROUP 4.....\$ 24.46 7.31

GROUP 5.....\$ 24.98 7.31

GROUP 6.....\$ 25.65 7.31

GROUP 7.....\$ 26.30 7.31

GROUP 8.....\$ 27.16 7.31

LABORERS CLASSIFICATIONS:

GROUP 1: Carloaders, choker setter, concrete crewman, crushed feeder, demolition laborers, including salvaging all material, loading, cleaning up, wrecking, dumpmen, flagmen, fence erector and installer (other than chain link), including installation and erection of fence, guard rails, medial rails, reference posts, guide posts and right-of-way markers, form strippers, general laborers, railroad track laborers, riprap man, scale man, stake jumper, structure mover, includes foundation, separation, preparation, cribbing, shoring, jacking and unloading of structures, water nozzleman, timber buckler and faller, truck loader, water boys, tool room men.

GROUP 2: Combined air and water nozzleman, cement handler, dope pot fireman (nonmechanical), form cleaning machine, mechanical railroad equipment (includes spiker, puller, tile cleaner, tamper, pipe wrapper, power driven wheelbarrows, operators of hand derricks, towmasters, scootcretes, buggymobiles and similar equipment), tamper or rammer operator, trestle scaffold builders over one tier high, power tool operator (gas, electric or pneumatic), sandblast or gunnite tailhose man, scaffold erector, (steel or wood), vibrator operator (up to 4 feet), asphalt cutter, mortar men, shorer and lagger, creosote material handler, corrosive enamel or equal, paver breaker and jackhammer operators.

GROUP 3: Multi-section pipe layer, non-metallic clay and concrete pipe layer (including caulker, collarman, jointer, rigger and jacker, thermal welder and corrugated metal culvert

pipe layer.

GROUP 4: Asphalt block pneumatic cutter, asphalt roller, walker, chainsaw operator with attachment, concrete saw (walking), high scalers, jackhammer operator (using over 6 feet of steel), vibrator operator (4 feet and over), well point installer, air trac operator.

GROUP 5: Asphalt screeder, big drills, cut of the hole drills (1 1/2 " piston or larger), down the hole drills (3 1/2" piston or larger) gunnite or sandblaster nozzleman, asphalt raker, asphalt tamper, form setter, demolition torch operator, shotcrete nozzlemen and potman.

GROUP 6: Powderman, master form setters.

GROUP 7: Brick paver (asphalt block paver, asphalt block sawman, asphalt block grinder, hastings block or similar type)

GROUP 8: Licensed powdermen.

LABO0657-004 06/01/2015

Rates Fringes

Laborers: (HAZARDOUS WASTE
REMOVAL, EXCEPT ON MECHANICAL
SYSTEMS:

Preparation for, removing and

encapsulation of hazardous materials from non-mechanical systems)

Skilled Asbestos Abatement Laborers.....	\$ 20.26	7.31
Skilled Toxic and Hazardous Waste Removal Laborers.....	\$ 22.93	7.31

LABO0657-005 06/01/2015

Rates Fringes

Laborers: (TUNNEL, RAISE & SHAFT (FREE AIR) FOR HEAVY AND SEWER & WATER LINES CONSTRUCTION)

GROUP 1.....	\$ 24.54	7.31
GROUP 2.....	\$ 25.32	7.31
GROUP 3.....	\$ 27.30	7.31
GROUP 4.....	\$ 28.14	7.31

LABORERS CLASSIFICATIONS:

GROUP 1: Brakeman, Bull Gang, Dumper, Trackmen, Concrete Man.

GROUP 2: Chuck Tender, Powdermen in Prime House, Form Setters and Movers, Nippers, Cableman, Houseman, Groutman, Bell or Signalman, Top or Bottom Vibrator Operator.

GROUP 3: Miners, Re-Bar Underground, Concrete or Gunnite
 Nozzlemen, Powdermen, Timbermen and Re-Timbermen, Wood Steel
 Including Liner plate or Other Support, Material Motorman,
 Caulkers, Diamond Drill Operators, Riggers, Cement Finishers-
 Underground, Welders and Burners, Shield Driver, Air Trac
 Operator, Shotcrete Nozzlemen and Potman.

GROUP 4: Mucking Machine Operator (Air).

LABO0657-006 06/01/2015

Rates Fringes

Laborers: (TUNNEL, RAISE AND
 SHAFT (COMPRESSED AIR) FOR
 HEAVY CONSTRUCTION ONLY

Gauge Pressure Work Period

(Pounds)	(Hours)		
1-14	7.....	\$ 32.45	7.31
14-18	6.....	\$ 38.19	7.31

FOOTNOTE: On any requirement for air pressure in excess of 18
 PSI, work periods and rates should be negotiated at a
 pre-bid conference.

LABO0657-007 08/01/2014

Rates Fringes

Laborers: (PAVING AND
INCIDENTAL GRADING)

Asphalt Raker & Concrete		
Saw Operator.....	\$ 19.80	6.60
Asphalt Shoveler.....	\$ 19.17	6.60
Asphalt Tammer & Concrete		
Shoveler.....	\$ 19.44	6.60
Jack Hammer.....	\$ 19.67	6.60
Laborer.....	\$ 19.00	6.60
Sand Setter & Form Setter...	\$ 20.48	6.60

LABO0657-008 06/01/2015

Rates Fringes

LABORERS (BRICK MASONRY WORK)

Mason Tenders.....	\$ 16.54	7.31
Scaffold Builders,		
Mortarmen.....	\$ 17.53	7.31

MARB0002-003 05/03/2015

Rates Fringes

Marble & Stone Mason

Includes Pointing,
Caulking and Cleaning of

All Types of Masonry,
 Brick, Stone and Cement
 Structures.....\$ 35.19 15.72

MARB0003-001 05/03/2015

Rates Fringes

Mosaic & Terrazzo Worker,
 Tile Layer.....\$ 26.75 10.28

MARB0003-004 05/03/2015

Rates Fringes

Marble, Tile & Terrazzo
 Finisher.....\$ 21.96 9.35

PAIN0051-001 06/01/2014

Rates Fringes

Painters:

All Industrial Work.....\$ 29.60 9.05
 Bridges, Heavy Highway,
 Lead Abatement and
 Flame/Thermal Spray.....\$ 33.23 9.05
 Commercial and Mold
 Remediation, Painters,

Wallcovers and Drywall		
Finishers.....	\$ 24.89	9.05
Metal Polishing and		
Refinishing.....	\$ 25.89	9.05

PLAS0891-001 02/01/2014

	Rates	Fringes
--	-------	---------

Cement Masons:

HEAVY CONSTRUCTION ONLY.....	\$ 27.15	9.61
------------------------------	----------	------

PLAS0891-002 06/01/2014

	Rates	Fringes
--	-------	---------

Cement Masons: (PAVING &
INCIDENTAL GRADING)

Cement Masons.....	\$ 19.50	6.91
Concrete Saw Operators.....	\$ 19.50	6.91
Form Setters.....	\$ 19.50	6.91

PLUM0005-001 08/01/2014

	Rates	Fringes
--	-------	---------

Plumbers.....	\$ 38.92	16.35+a
---------------	----------	---------

a. PAID HOLIDAYS: Labor Day, Veterans' Day, Thanksgiving

Day and the day after Thanksgiving, Christmas Day, New Year's Day, Martin Luther King's Birthday, Memorial Day and the Fourth of July.

PLUM0602-005 08/01/2014

Rates Fringes

Steamfitter, Refrigeration &

Air Conditioning Mechanic.....\$ 38.24 19.42+a

a. PAID HOLIDAYS: New Year's Day, Martin Luther King's Birthday, Memorial Day, Independence Day, Labor Day, Veterans Day, Thanksgiving Day and the day after Thanksgiving and Christmas Day.

SHEE0100-001 07/01/2015

Rates Fringes

Sheet Metal Worker.....\$ 39.79 16.77+a

a. PAID HOLIDAYS: New Year's Day, Martin Luther King's Birthday, Memorial Day, Independence Day, Labor Day, Veterans Day, Thanksgiving Day and Christmas Day

TEAM0639-001 06/01/2014

Rates Fringes

Truck drivers: (HEAVY &
HIGHWAY CONSTRUCTION)

Tractor trailer, Low Boy....\$ 22.60 2.20+a

Truck Drivers.....\$ 20.60 2.20+a

a. VACATION: Employees will receive one (1) week's paid
vacation after one (1) year of service.

TEAM0639-005 06/01/2014

Rates Fringes

Truck drivers: (PAVING &
INCIDENTAL GRADING)

All paving projects where
the grading is incidental
to the paving.....\$ 20.60 2.20

WELDERS - Receive rate prescribed for craft performing
operation to which welding is incidental.

=====

Unlisted classifications needed for work not included within the scope of the classifications listed may be added after award only as provided in the labor standards contract clauses (29CFR 5.5 (a) (1) (ii)).

The body of each wage determination lists the classification and wage rates that have been found to be prevailing for the cited type(s) of construction in the area covered by the wage determination. The classifications are listed in alphabetical order of "identifiers" that indicate whether the particular rate is a union rate (current union negotiated rate for local), a survey rate (weighted average rate) or a union average rate (weighted union average rate).

Union Rate Identifiers

A four letter classification abbreviation identifier enclosed in dotted lines beginning with characters other than "SU" or "UAVG" denotes that the union classification and rate were prevailing for that classification in the survey. Example: PLUM0198-005 07/01/2014. PLUM is an abbreviation identifier of the union which prevailed in the survey for this classification, which in this example would be Plumbers. 0198 indicates the local union number or district council number

where applicable, i.e., Plumbers Local 0198. The next number, 005 in the example, is an internal number used in processing the wage determination. 07/01/2014 is the effective date of the most current negotiated rate, which in this example is July 1, 2014.

Union prevailing wage rates are updated to reflect all rate changes in the collective bargaining agreement (CBA) governing this classification and rate.

Survey Rate Identifiers

Classifications listed under the "SU" identifier indicate that no one rate prevailed for this classification in the survey and the published rate is derived by computing a weighted average rate based on all the rates reported in the survey for that classification. As this weighted average rate includes all rates reported in the survey, it may include both union and non-union rates. Example: SULA2012-007 5/13/2014. SU indicates the rates are survey rates based on a weighted average calculation of rates and are not majority rates. LA indicates the State of Louisiana. 2012 is the year of survey on which these classifications and rates are based. The next number, 007 in the example, is an internal number used in producing the wage determination. 5/13/2014 indicates the survey completion date for the classifications and rates under that identifier.

Survey wage rates are not updated and remain in effect until a new survey is conducted.

Union Average Rate Identifiers

Classification(s) listed under the UAVG identifier indicate that no single majority rate prevailed for those classifications; however, 100% of the data reported for the classifications was union data. EXAMPLE: UAVG-OH-0010 08/29/2014. UAVG indicates that the rate is a weighted union average rate. OH indicates the state. The next number, 0010 in the example, is an internal number used in producing the wage determination. 08/29/2014 indicates the survey completion date for the classifications and rates under that identifier.

A UAVG rate will be updated once a year, usually in January of each year, to reflect a weighted average of the current negotiated/CBA rate of the union locals from which the rate is based.

WAGE DETERMINATION APPEALS PROCESS

1.) Has there been an initial decision in the matter? This can be:

- * an existing published wage determination
- * a survey underlying a wage determination

- * a Wage and Hour Division letter setting forth a position on a wage determination matter
- * a conformance (additional classification and rate) ruling

On survey related matters, initial contact, including requests for summaries of surveys, should be with the Wage and Hour Regional Office for the area in which the survey was conducted because those Regional Offices have responsibility for the Davis-Bacon survey program. If the response from this initial contact is not satisfactory, then the process described in 2.) and 3.) should be followed.

With regard to any other matter not yet ripe for the formal process described here, initial contact should be with the Branch of Construction Wage Determinations. Write to:

Branch of Construction Wage Determinations
Wage and Hour Division
U.S. Department of Labor
200 Constitution Avenue, N.W.
Washington, DC 20210

2.) If the answer to the question in 1.) is yes, then an interested party (those affected by the action) can request review and reconsideration from the Wage and Hour Administrator (See 29 CFR Part 1.8 and 29 CFR Part 7). Write to:

Wage and Hour Administrator
U.S. Department of Labor

200 Constitution Avenue, N.W.
Washington, DC 20210

The request should be accompanied by a full statement of the interested party's position and by any information (wage payment data, project description, area practice material, etc.) that the requestor considers relevant to the issue.

3.) If the decision of the Administrator is not favorable, an interested party may appeal directly to the Administrative Review Board (formerly the Wage Appeals Board). Write to:

Administrative Review Board
U.S. Department of Labor
200 Constitution Avenue, N.W.
Washington, DC 20210

4.) All decisions by the Administrative Review Board are final.

=====

END OF GENERAL DECISION

General Decision Number: MD150034 08/14/2015 MD34

Superseded General Decision Number: MD20140034

State: Maryland

Construction Type: Heavy

County: Montgomery County in Maryland.

HEAVY CONSTRUCTION PROJECTS (including sewer/water construction).

Note: Executive Order (EO) 13658 establishes an hourly minimum wage of \$10.10 for 2015 that applies to all contracts subject to the Davis-Bacon Act for which the solicitation is issued on or after January 1, 2015. If this contract is covered by the EO, the contractor must pay all workers in any classification listed on this wage determination at least \$10.10 (or the applicable wage rate listed on this wage determination, if it is higher) for all hours spent performing on the contract. The EO minimum wage rate will be adjusted annually. Additional information on contractor requirements and worker protections under the EO is available at www.dol.gov/whd/govcontracts.

Modification Number Publication Date

0 01/02/2015

1 05/01/2015

- 2 06/26/2015
- 3 07/17/2015
- 4 08/14/2015

* CARP0132-016 05/01/2015

	Rates	Fringes
CARPENTER (Including Form Work).....	\$ 27.56	9.08

ELEC0026-019 11/03/2014

	Rates	Fringes
ELECTRICIAN.....	\$ 42.40	14.97+a

a. PAID HOLIDAYS: New Year's Day, Inauguration Day, Martin Luther King Jr.'s Birthday, Memorial Day, Independence Day, Labor Day, Veterans' Day, Thanksgiving Day, the day after Thanksgiving Day and Christmas Day.

ENGI0077-014 05/01/2015

	Rates	Fringes
OPERATOR: Bulldozer.....	\$ 29.30	8.65+a
OPERATOR: Crane		

35 ton Cranes and Above.....	\$ 34.36	8.65+a
Cranes Below 35 tons.....	\$ 32.71	8.65+a
Tower and Climbing Cranes...	\$ 35.91	8.65+a
Tower Cranes and Cranes		
100 tons and Over.....	\$ 35.91	8.65+a
OPERATOR: Drill.....	\$ 34.36	8.65+a
OPERATOR: Excavator.....	\$ 29.30	8.65+a
OPERATOR: Mechanic.....	\$ 36.75	8.65+a
OPERATOR: Piledriver.....	\$ 32.71	8.65+a

a. PAID HOLIDAYS: New Year's Day, Inaugural Day, Decoration Day, Independence Day, Labor Day, Martin Luther King's Birthday, Veterans' Day, Thanksgiving Day, Friday after Thanksgiving and Christmas Day.

IRON0201-006 05/01/2015

	Rates	Fringes
IRONWORKER, REINFORCING.....	\$ 27.50	18.58

LABO0657-019 06/01/2015

	Rates	Fringes
LABORER: Mason Tender - Cement/Concrete.....	\$ 24.06	7.31

PAIN0051-020 06/01/2013

	Rates	Fringes
PAINTER: Steel.....	\$ 32.66	8.91

PLAS0891-006 02/01/2014

	Rates	Fringes
CEMENT MASON/CONCRETE FINISHER...	\$ 27.15	9.61

TEAM0639-008 06/01/2014

	Rates	Fringes
TRUCK DRIVER, Includes Dump Truck.....	\$ 20.60	2.20+a
TRUCK DRIVER: Lowboy Truck.....	\$ 22.60	2.20+a

a.VACATION: Employees will receive one (1) week's paid vacation after one (1)year of service.

SUMD2010-073 07/08/2010

	Rates	Fringes
IRONWORKER, STRUCTURAL.....	\$ 24.00	10.16

LABORER: Common or General.....	\$ 14.01	0.00
LABORER: Flagger.....	\$ 15.71	8.58
LABORER: Grade Checker.....	\$ 14.62	3.08
LABORER: Landscape.....	\$ 17.72	8.58
LABORER: Mason Tender - Brick...	\$ 15.93	7.83
LABORER: Pipelayer.....	\$ 15.50	0.00
OPERATOR: Backhoe.....	\$ 22.00	0.00
OPERATOR: Bobcat/Skid Steer/Skid Loader.....	\$ 16.41	5.15
OPERATOR: Gradall.....	\$ 20.50	8.89
OPERATOR: Grader/Blade.....	\$ 19.00	5.00
OPERATOR: Loader.....	\$ 17.50	0.00
OPERATOR: Mechanic.....	\$ 22.12	6.22
OPERATOR: Paver (Asphalt, Aggregate, and Concrete).....	\$ 17.53	9.07

OPERATOR: Piledriver.....\$ 19.95 4.50

OPERATOR: Roller.....\$ 16.50 5.34

OPERATOR: Trackhoe.....\$ 18.98 7.32

PAINTER: Brush, Roller and
Spray.....\$ 24.32 6.91

PIPEFITTER.....\$ 22.51 6.47

WELDERS - Receive rate prescribed for craft performing
operation to which welding is incidental.

=====

Unlisted classifications needed for work not included within
the scope of the classifications listed may be added after
award only as provided in the labor standards contract clauses
(29CFR 5.5 (a) (1) (ii)).

The body of each wage determination lists the classification
and wage rates that have been found to be prevailing for the

cited type(s) of construction in the area covered by the wage determination. The classifications are listed in alphabetical order of "identifiers" that indicate whether the particular rate is a union rate (current union negotiated rate for local), a survey rate (weighted average rate) or a union average rate (weighted union average rate).

Union Rate Identifiers

A four letter classification abbreviation identifier enclosed in dotted lines beginning with characters other than "SU" or "UAVG" denotes that the union classification and rate were prevailing for that classification in the survey. Example:

PLUM0198-005 07/01/2014. PLUM is an abbreviation identifier of the union which prevailed in the survey for this classification, which in this example would be Plumbers. 0198 indicates the local union number or district council number where applicable, i.e., Plumbers Local 0198. The next number, 005 in the example, is an internal number used in processing the wage determination. 07/01/2014 is the effective date of the most current negotiated rate, which in this example is July 1, 2014.

Union prevailing wage rates are updated to reflect all rate changes in the collective bargaining agreement (CBA) governing this classification and rate.

Survey Rate Identifiers

Classifications listed under the "SU" identifier indicate that no one rate prevailed for this classification in the survey and the published rate is derived by computing a weighted average rate based on all the rates reported in the survey for that classification. As this weighted average rate includes all rates reported in the survey, it may include both union and non-union rates. Example: SULA2012-007 5/13/2014. SU indicates the rates are survey rates based on a weighted average calculation of rates and are not majority rates. LA indicates the State of Louisiana. 2012 is the year of survey on which these classifications and rates are based. The next number, 007 in the example, is an internal number used in producing the wage determination. 5/13/2014 indicates the survey completion date for the classifications and rates under that identifier.

Survey wage rates are not updated and remain in effect until a new survey is conducted.

Union Average Rate Identifiers

Classification(s) listed under the UAVG identifier indicate that no single majority rate prevailed for those classifications; however, 100% of the data reported for the classifications was union data. EXAMPLE: UAVG-OH-0010 08/29/2014. UAVG indicates that the rate is a weighted union average rate. OH indicates the state. The next number, 0010 in the example, is an internal number used in producing the wage determination. 08/29/2014 indicates the survey completion date for the classifications and rates under that identifier.

A UAVG rate will be updated once a year, usually in January of each year, to reflect a weighted average of the current negotiated/CBA rate of the union locals from which the rate is based.

WAGE DETERMINATION APPEALS PROCESS

1.) Has there been an initial decision in the matter? This can be:

- * an existing published wage determination
- * a survey underlying a wage determination
- * a Wage and Hour Division letter setting forth a position on a wage determination matter
- * a conformance (additional classification and rate) ruling

On survey related matters, initial contact, including requests for summaries of surveys, should be with the Wage and Hour Regional Office for the area in which the survey was conducted because those Regional Offices have responsibility for the Davis-Bacon survey program. If the response from this initial contact is not satisfactory, then the process described in 2.) and 3.) should be followed.

With regard to any other matter not yet ripe for the formal process described here, initial contact should be with the Branch of Construction Wage Determinations. Write to:

Branch of Construction Wage Determinations
Wage and Hour Division
U.S. Department of Labor
200 Constitution Avenue, N.W.
Washington, DC 20210

2.) If the answer to the question in 1.) is yes, then an interested party (those affected by the action) can request review and reconsideration from the Wage and Hour Administrator (See 29 CFR Part 1.8 and 29 CFR Part 7). Write to:

Wage and Hour Administrator
U.S. Department of Labor
200 Constitution Avenue, N.W.
Washington, DC 20210

The request should be accompanied by a full statement of the interested party's position and by any information (wage payment data, project description, area practice material, etc.) that the requestor considers relevant to the issue.

3.) If the decision of the Administrator is not favorable, an interested party may appeal directly to the Administrative Review Board (formerly the Wage Appeals Board). Write to:

Administrative Review Board
U.S. Department of Labor
200 Constitution Avenue, N.W.
Washington, DC 20210

4.) All decisions by the Administrative Review Board are final.

=====

END OF GENERAL DECISION

- g. Temporarily support during construction existing conduits under platform overhang that are located directly below platform structural work, and replace only severely corroded conduits. Cables and wiring in conduit to be replaced shall be replaced between termination points without splices. Provide temporary conduit and wiring as required during construction to ensure continuity of service. Trace wiring to be replaced and determine all termination points. Exposed cables located directly under structural platform repair work shall be temporarily relocated. Protect existing to remain conduits and cables during platform structural work.
- h. Replace existing platform edge flashing lights, including associated wiring and platform-embedded conduit. Replace associated existing flasher/dimmer control panels located in both AC switchboard rooms. Maintain operation of platform edge flashing lights during revenue service.
- i. Disconnect and reconnect platform mounted equipment that will be temporarily removed during platform work, including pylons, and wind shelters and associated dioramas. Restore existing grounding connections, and/or provide new grounding connections as required.
- j. All globes and luminaires shall be replaced under this Work. WMATA will provide missing fixtures to the Design-Builder to install. Any defective wiring will be addressed by WMATA. Testing is required by the Design-Builder.
2. Structural work shall include:
- a. Install temporary platform support structure for active work areas.
- b. Remove portions of the existing platform as shown, restricting each portion of removal to that amount that can be restored to service within the time constraints of the allowable track occupancy.
- c. Drill holes in existing slabs for installation of rebar to support new cantilevered slab extensions.
- d. Install new waterproofing termination curb around existing Dispatch Office at North end of platform.
3. Mechanical work shall include:
- a. Under platform fire standpipe and canopy drain lines:
- (1) In cases where the current piping location does not interfere with platform replacement work but the piping is supported from the platform above or from the affected under platform plenum walls, mechanical work may be temporarily supported during the construction process. New supports shall be installed when the platform reconstruction is complete.
- (2) In cases where existing piping will penetrate the new platform sections, the contractor shall identify the size and location of the necessary mechanical blockouts.
- (3) The Contractor may propose relocation of existing piping in cases where this is beneficial in terms of work efficiency.
- (4) Contractor's proposed changes to piping and mechanical equipment shall be tested in accordance with procedures contained in Division 15 specifications.
- b. Refer to the Reference drawings for treatment of mechanical equipment located in the spaces that will be disturbed by the platform replacement.

AM4
AM4

AM2
AM2
AM2

- c. Identify any proposed modifications to ventilation openings that are necessary to accommodate platform replacement work and make the required modifications upon Contracting Officer Representative Approval.
4. Architectural finishes shall include:
- a. Remove granite edge stone from platform in accordance with Section 04415 and replace with new granite edge stone per Section 04415 and the Contract Drawings. Salvage all granite edge stone where possible for WMATA future maintenance use and load, transport and unload salvaged granite edge stone as indicated by the AR to WMATA facility within the vicinity of Metrorail system. Remove and dispose of damaged granite edges. **AM2**
 - b. Existing quarry tile, setting bed and topping slab shall be replaced with precast concrete pavers, applied to the top surface the entire platform (full width). Both precast pavers and precast detectable warning panels with domes are required throughout the platform. Station furniture and pylons will be removed and/ or reinstalled in the process of installing the new pavers; except that dispatch office will remain in place. **AM2**
 - c. The finished paver surface of the platform shall have the required cross-slope with no depressions or tripping hazards. **AM2**
 - d. Expansion joints, sealants, joint fillers, waterproof membrane and other miscellaneous elements shall be installed as shown. **AM2**
5. Safety
- a. At all times during active construction barricades, warning signs, and dust/debris screens shall be erected as necessary to protect passengers, Authority personnel, and facilities to remain. At the completion of each allowed work period such temporary devices shall be adjusted to a configuration that will not impede normal revenue operations in the station.
 - b. Procedures shall be established to ensure that there will be no encroachment by personnel, materials or equipment into the right-of-way of the adjacent freight railroad.
 - c. The safety requirements specified herein shall be included in the detailed work sequence.
- J. Part 5 - Grosvenor-Strathmore Platform Canopy and Mezzanine Roof Retrofit Design-Build
1. Architectural work shall include:
- a. Replace canopy roofing for upper and lower roofs.
 - b. Raise or replace platform canopy skylight and provide transition between platform and mezzanine skylights.
 - c. Install new scupper drains, gutter, downspouts, and metal panel fascia on mezzanine canopy roof. Metal fascia panels on mezzanine only. Platform canopy drip edge is to extend beyond center line of train car beneath. **AM4**
2. Mechanical work shall include:
- a. Mechanical work shall include modifications to the existing Grosvenor-Strathmore Station roof drainage. **AM4**
 - b. Existing roof drains shall be filled and abandoned in place.
 - c. Scupper drains, which route out through the building wall and to a gutter around the perimeter of the roof, shall be added to each roofing section on the mezzanine roof to

replace the abandoned roof drains. Drain leaders shall route all drainage from gutter to grade with downspouts at each structural column.

- d. The platform canopy roof shall be modified to allow water to drip off the edge of the roof and onto the track bed.

K. Part 6 - Bethesda Station New South Mezzanine Design-Build (Option 1A)

1. Design a new south mezzanine at Bethesda Station to accommodate the future connection of the Purple Line based on Authority furnished conceptual design, specifications, WMATA Manual of Design Criteria and Program Requirements, and supplemental documents included or referenced within the Contract documents. See Section 01112, DESIGN AND PROGRAM REQUIREMENTS for a complete description of design requirements.
2. The design of the south mezzanine shall complement the existing north mezzanine construction. Design shall take into account temporary lighting, power and ventilation needs that are required such that the platform remains fully operational during Option 1B construction and until Purple Line access and mezzanine finishes are completed by others. The design documents shall clearly denote work that shall be constructed under Option 1B versus future finishes and systems that will be completed by others. A temporary fully grouted 8" CMU wall with a two hour fire rated door shall be designed to seal off the unfinished MTA Purple Line construction from the WMATA south mezzanine bridge. All design deliverables shall become Authority property upon completion of the design by the Design-Builder and Approval of the design by the Authority.

L. Part 6 - Bethesda Station New South Mezzanine Design-Build (Option 1B)

1. Construct, test and commission all elements of the new south mezzanine that will require Revenue Service Adjustment (RSA) track shutdowns during construction. See Table 01110-01 for description of these elements. WMATA will relocate 4 cables located above the trackbed lighting grate which route along the inbound track at the new passageway knockout panel area.
Table 01110-01: Summary of Option 1B Construction

AM4
AM4

Elements of Work	Option 1A Design	Option 1B Construction	Future Work (not in contract)
Precast station vault knockout panels	As defined in Section 01112, DESIGN AND PROGRAM REQUIREMENTS	Removal; concrete below and surrounding the mezzanine connection to passageway; temporary CMU wall on the passageway.	CIP concrete above mezzanine metal deck; embedded conduits.
Below platform cable and piping	Same as above	Reroute as needed and restore functions (may involve other station facilities) for revenue operations	
Elevators	Same as above	Platform cutout; foundations; restore platform to include access panel with paver tile finish, expansion joints, and sealant; framed opening at future mezzanine cutout; machine room.	Elevator shaft structures, cars and equipment.

1. The majority of materials and equipment needed to perform the work must be moved over the rail system using rail-mounted equipment which shall be provided by Design-Builder. Only limited windows of time will be made available for such movements. All such movements must be coordinated with the AR and must be made in accordance with procedures for such moves published by the Authority. All vehicles used for such movements are subject to approval and must comply with the clearance, wheel loading, and total weight restrictions published by the Authority.
 2. During permitted work periods, one or two tracks may be removed from passenger service and will be available for use by Contractor's equipment and forces. The track shut-down area will include both stations and a short portion of track beyond each station. Rail-mounted equipment will be permitted to occupy these portions of the track, including movements between stations, during these track outages.
 3. Passenger service will continue on the opposite track during weekend s i n g l e t r a c k i n g during normal revenue service hours and Authority maintenance operations will continue on the opposite track at other times. No activity of the Contractor shall interfere with such operations.
 4. Contractor can use WMATA asphalt maintenance road located between Grosvenor Avenue and Pier A5290 in the median of Rockville Pike (MD 355) in Rockville, MD to perform repairs on aerial structures. The access road south of Grosvenor station may also be used. **AM4**
 5. Area near portal (between Medical Center and Grosvenor station) can be used to load any equipment and precast members if one lane on Route 355 is closed to traffic. Contractor is responsible for following traffic closures (MUTCD) requirements and getting approval from MD SHA and/or local municipality for setting up the lane closures.
 6. The area between the tracks immediately south of the Grosvenor Station may be used for staging. **AM4**
- B. Coordinate with Contracting Officer Representative for staging of Construction equipment and materials within Authority Roadway and Authority property. At the completion of each allowable work period, the stations and tracks will be restored to normal service. The station work areas shall be left in a condition to permit such operation with no impact on the safety of passengers or the safe operation of trains
- C. Parking
1. WMATA will not provide parking spaces for the Design-Builder.
- D. Constraints on Construction
1. Work Sequence
 - a. Construction shall follow the specified directions provided in the contract drawings and technical specifications as applicable.
 - b. Listed all the parts of the work shall be performed simultaneously when the Authority approved access to work sites are available to the Design-Builder.
 2. Special Events
 - a. Minimize risks to the public during special community events that are located in close proximity to the Project Site.
 - b. Construction activities shall be coordinated with the Authority to reduce construction impacts.
 - c. Maintain a Special Community Event List in coordination with the Authority for the duration of the Contract. The list shall identify local special holidays, parades, festivals, and other

2. Construction Manager

- a. Shall have an undergraduate degree in engineering or construction management with a minimum of 15 years experience in managing complex multi-discipline heavy construction projects and a minimum of 10 years managing the construction of projects of a similar type and financial magnitude in the transit industry.
- b. Responsible for managing construction of all facets of the Project.
- c. In charge of the day-to-day construction activity of the Project. Responsibilities include but are not limited to acquiring construction permits, managing Subcontractors, independent testing companies, fabricators and Suppliers, coordinating with Quality Manager and Safety Manager in the implementation of project Quality and Safety plans, development, management, and implementation of Project Schedule, preparation, submittal, and management of construction submittals, maintaining As-Built documentation, coordinating with Design Engineering Manager, outside agencies, and Utility companies on construction related matters. The Construction Manager is responsible to ensure that construction is based on Approved Final Design Drawings Issued for Construction and Approved Final Design Specification Issued for Construction and that all applicable codes and standards are complied with.

AM4

3. Construction General Superintendent

- a. Shall have a minimum of 15 years experience in complex multi-discipline heavy construction, a minimum of 10 years in transit industry, and a minimum of 5 years in a supervisory capacity supervising projects of a similar type and financial magnitude.
- b. Responsible for oversight of day-to-day construction at the Site.
- c. Responsibilities include but are not limited to supervising construction activity, overseeing coordination between Subcontractors, and ensuring that construction is based on current Shop Drawings and Working Drawings. The Construction General Superintendent is also responsible for maintaining as-built documentation.

4. Quality Manager

- a. A degreed engineer and trained as a Lead Auditor in a Registrar Accreditation Board of the American Society for Quality (RABASQ) approved course on the requirements of ISO 9001 and with a minimum of 10 years of related experience including a minimum of 5 years of management positions in a production, manufacturing, or construction environment performing QA/QC auditing. Transit industry experience is preferred.
- b. Reports to one or more levels of management above the Design-Builder's Project Manager.
- c. Responsible for the Quality Assurance (QA) and Quality Control (QC) for the Project and shall be fully familiar with the Federal Transit Agency's (FTA) Quality requirements.
- d. Shall be a full time staff member of the Design-Builder and shall establish, implement, and maintain the Quality Management System, shall report directly to and be supervised by an Officer of the Design-Builder at a level above that of the Project Manager responsible for the Project, shall serve as a liaison officer with the Authority and the Jurisdictional Authorities on matters relating to the Design-Builder's quality system, shall be responsible for ensuring that the Quality Management System is effective in ensuring that the Contract requirements are satisfied, and shall be responsible for the oversight of onsite and offsite testing by the Design-Builder.
- e. The Quality Manager may be approved as the Safety and Security Certification Manager as defined in Section 01115, SAFETY AND SECURITY CERTIFICATION.

- k. Statement by the Design Professional who signed the drawings that the drawings and specifications conform to applicable architectural, engineering, systems and Authority requirements and to the appropriate jurisdictional regulations as specified in Section 01112, DESIGN AND PROGRAM REQUIREMENTS and Section 01470, QUALITY REQUIREMENTS.
- l. Design survey field notes as applicable as specified in Section 01721, LAYOUT OF WORK AND FIELD ENGINEERING.
- m. Product data including cut sheets to demonstrate compliance with the Contract Documents and Final estimated quantities for all types of materials to be permanently incorporated into the project.

G. Issued For Construction

1. Design Drawings, Design Specifications, and calculations signed and sealed by Architect and Engineer of Record. In some cases, construction may commence before the complete 100% Final Design Drawings and Specifications are produced and issued to the Authority for consideration. In such cases, an additional submittal shall be required from the Design-Builder consisting of all Design Drawings, Design Specifications, and other materials needed to review and approve the work that the Design-Builder intends to construct. Secure Authority Approval before construction or fabrication of any Work indicated by a required design submittal.
 2. Final Design Drawings include elements of Work that are not a part of Bethesda South Mezzanine construction in Option 1B. Consequently, Approved Final Design Drawings Issued for Construction shall be prepared to show only the Work that will be constructed in Option 1B as defined in Section 01110, SUMMARY OF WORK.
 3. Preparation of Issued for Construction documents is a part of Option 1A whether Option 1B is exercised by the Authority or not.
- H. Other Design Reviews: The Authority retains the right to review and approve for conformance to the Project Requirements any other submittals that it deems necessary during the Design Phase for Parts 5 and 6 of this Contract. In addition, the Design-Builder shall provide all other submittals to the Authority that are specified in the Project Manual beyond those referenced above and as listed on the approved Schedule of Submittals.

1.07 PROJECT SPECIFIC DESIGN REQUIREMENTS

- A. Listed below are project-specific design requirements that supplement WMATA Manual of Design Criteria, Contract Drawings, and Contract Specifications. In cases of conflict, these requirements shall take precedence over the WMATA Manual of Design Criteria, Contract Drawings, and Contract Specifications.
- B. Grosvenor-Strathmore Platform Canopy and Mezzanine Roof Retrofit Design-Build (GDB)
 1. General - Design-Builder shall complete design for the following:
 - a. Replace canopy roof for mezzanine and platform;
 - b. Raise or replace platform canopy skylight;
 - c. Install new scupper drains, gutter, downspouts on mezzanine canopy roof;
 - d. Provide metal panel fascia on mezzanine canopy roof only.
 - e. Provide new openings through existing mezzanine concrete beams to direct water to follow new drainage patterns.

AM4

- f. Scupper drains, which route through the existing concrete fascia beams to a gutter shall be provided continuously on the mezzanine roof to replace the abandoned roof drains. Drain leaders shall route all drainage from gutter to grade with downspouts at each structural column.
2. Design for Grosvenor-Strathmore Station Platform Canopy:
 - a. If existing platform skylight is replaced, design new skylight. If existing platform skylight is retained, design temporary support to raise skylight if it will be supported in place during steel curb installation.
 - b. Design steel curb to raise skylight such that new roof can be properly flashed at junction with skylight.
 - c. Design skylight transition section where skylight slopes from platform canopy to mezzanine canopy.
 - d. Design roof system such that water drains toward outside canopy edges. Minimum slope toward outside canopy edges shall be 1/4-inch per foot. Edge shall extend beyond center line of Train Car beneath.
 - e.
 - f. Provide design for associated Work as needed.
3. Design for Grosvenor-Strathmore Station Mezzanine Canopy:
 - a. Design new roof system to replace existing roof system to be removed. New roof system shall be installed on all horizontal slab and beam surfaces as well as vertical faces of transverse beams.
 - b. Design concrete patch to fill obsolete drain openings in mezzanine canopy.
 - c. Design drainage collection system such that all canopy bays have positive drainage. Drilling new holes in concrete fascia beam is not permitted in bays within 8'-4" of existing columns. In bays where penetrations are permitted, verify locations of existing reinforcing steel in beams prior to core drilling. Drainage collection system shall include scuppers, gutters and downspouts. Provide gutter width, gutter depth and downspout size calculations.
 - d. In bays where core drilling through fascia beam is not permitted, enlarge existing drain holes in transverse beams (perpendicular to fascia beams) or drill new drainage holes in transverse beams to allow drainage into adjacent bays. Verify locations of existing reinforcement in transverse beams.
 - e. Design tapered insulation crickets to direct storm water toward scupper drains and drainage holes through transverse beams where there are no scupper drains.
 - f. Design new metal coping on existing concrete fascia beam to protect steel reinforcement on the outside of the fascia beam from water damage.
 - g. Design composite metal rain screen panel fascia on the outside face of the concrete fascia beam and wrap around the underside of the beam and up the inside face as indicated on the drawings. Detail how the rain screen fascia will be furred out sufficiently to allow gutter and metal panels to bypass reinforcing at columns on outside, bottom and inside face.

AM4
AM4
AM4
AM4

C. Bethesda Station South Mezzanine Design-Build (Option 1A)

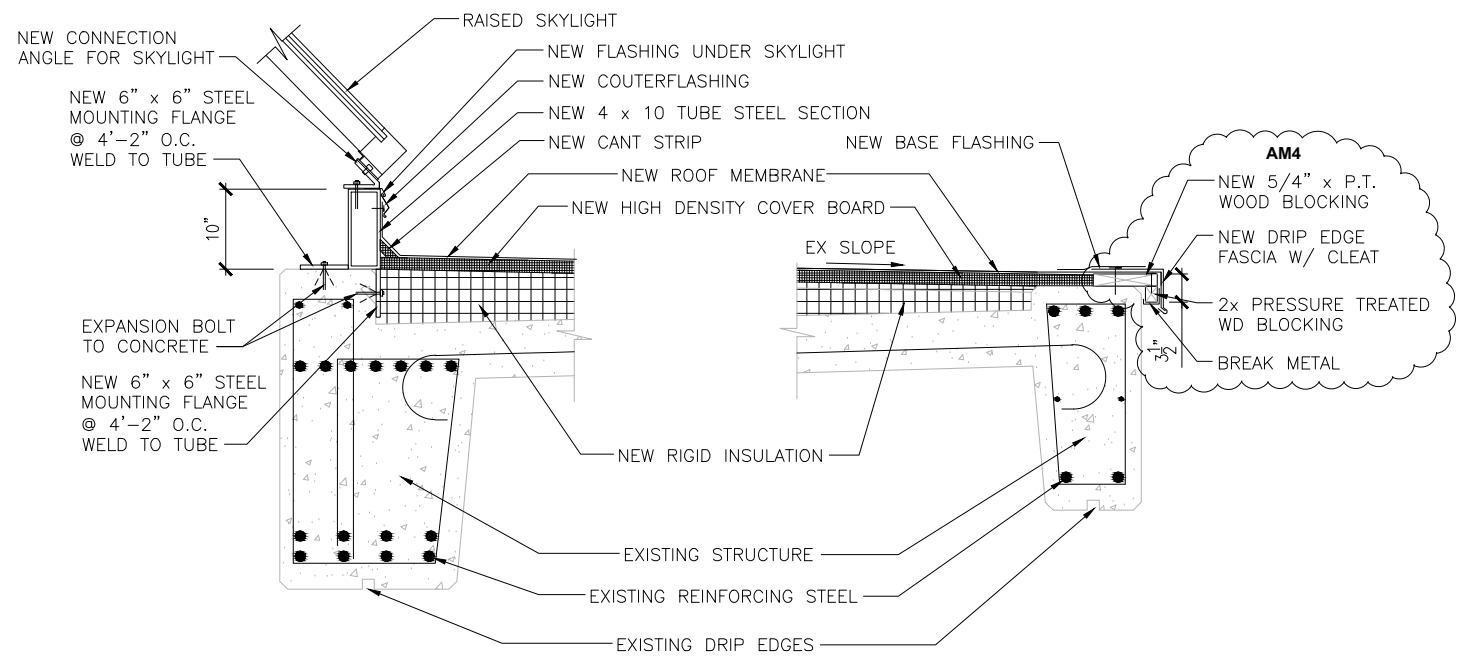

1 LOWER ROOF - DETAIL AT SKYLIGHT
SCALE: 1"=1'-0"

2 LOWER ROOF - DETAIL AT EDGE
SCALE: 1"=1'-0"

GENERAL NOTES:

1. WHEN ANCHORING, SHOOTING, DRILLING, CHIPPING, OR CORING INTO CONCRETE, THE AREA SHALL BE X-RAYED, FERRO SCANNED, OR SCANNED USING GROUND PENETRATION RADAR (GPR) PRIOR TO START OF WORK. DO NOT CUT OR NICK EXISTING REINFORCING
2. CONTRACTOR IS TO VERIFY THE LOCATIONS OF EXISTING REBARS, AND IS NOT TO DISTURB OR DAMAGE THE REBAR.

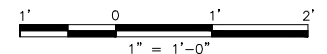

FINAL CONTRACT NO. FQ15093

DESIGNED	DATE	REFERENCE DRAWINGS		REVISIONS	
		NUMBER	DESCRIPTION	DATE	DESCRIPTION
JRS	4/30/14			8/21/15	REVISE DRIP EDGE - AM4
AD	7/16/14				
RES	7/22/14				
JP	7/28/14				

WASHINGTON METROPOLITAN AREA TRANSIT AUTHORITY

DEPARTMENT OF TRANSIT INFRASTRUCTURE AND ENGINEERING SERVICES
OFFICE OF INFRASTRUCTURE RENEWAL PROGRAM

APPROVED _____

GFP A Gannett Fleming/Parsons JOINT VENTURE

SUBMITTED _____
PROJECT MANAGER

RED LINE REHAB.-FRIENDSHIP HEIGHTS TO GROSVENOR - PART 5

ARCHITECTURAL LOWER ROOF DETAILS

SCALE AS SHOWN DRAWING NO. A11-A-551 SHEET NO. M1272-183

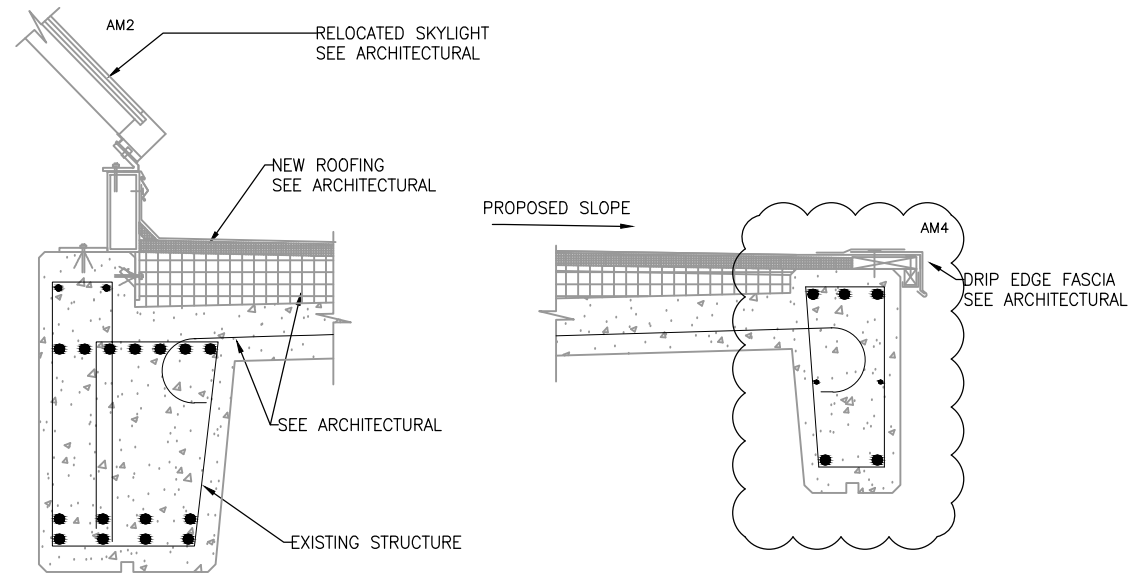

1 TYPICAL SECTION AT LOWER ROOF
SCALE: 1"=1'-0"

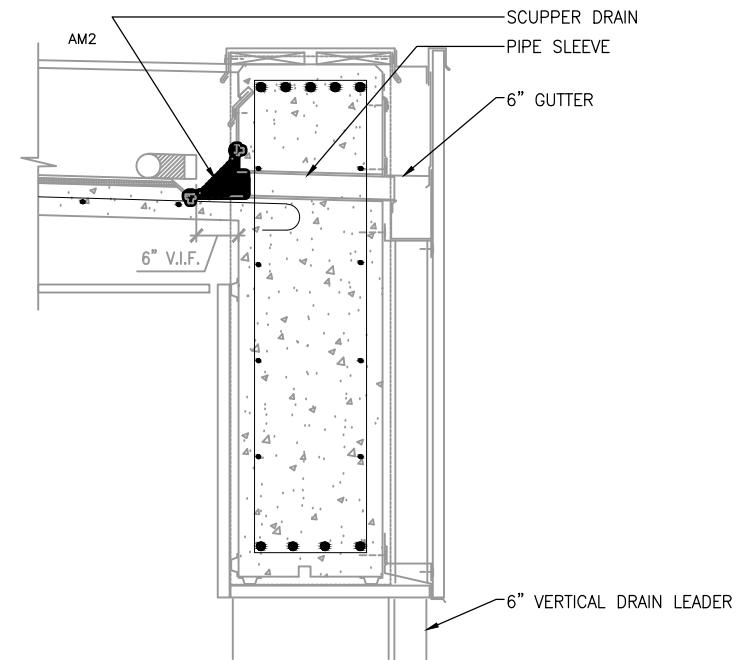

2 TYPICAL SECTION AT SCUPPER DRAIN
SCALE: 1"=1'-0"

PROFESSIONAL CERTIFICATION. I HEREBY CERTIFY THAT THESE DOCUMENTS WERE PREPARED OR APPROVED BY ME, AND THAT I AM A DULY LICENSED PROFESSIONAL ENGINEER UNDER THE LAWS OF THE STATE OF MARYLAND, LICENSE NO. 22331, EXPIRATION DATE: 05-03-2015.

6" 3" 0 3" 6" 1
SCALE: 1" = 1'-0"

FINAL CONTRACT NO. FQ15093

DESIGNED		DATE		NUMBER		DESCRIPTION		DATE		BY		DESCRIPTION	
DPR		01/2015						07/2015	DPR				UPDATE OF ARCH BACKGROUND - AM2
DPR		01/2015						08/2015	DPR				UPDATE OF ARCH BACKGROUND - AM4
CMR		01/2015											
JP		01/2015											



WASHINGTON METROPOLITAN AREA TRANSIT AUTHORITY

DEPARTMENT OF TRANSIT INFRASTRUCTURE
AND ENGINEERING SERVICES
OFFICE OF INFRASTRUCTURE RENEWAL PROGRAM

APPROVED _____



SUBMITTED _____
PROJECT MANAGER

RED LINE REHAB.-FRIENDSHIP HEIGHTS TO
GROSVENOR - PART 5
MECHANICAL ROOF PROPOSED SECTIONS

SCALE
AS SHOWN

DRAWING NO.
A11-M-350

SHEET NO.
M1272-188